



On these beams, we're building dreams



Padma Priya

Seyon 

2 @ 3 BHK Luxuries apprtment
@ JP Nagar 9th Phase

*"Owning a home is a
keystone of wealth"*

Padma Priya

Seyon

Padmapriya Seyon



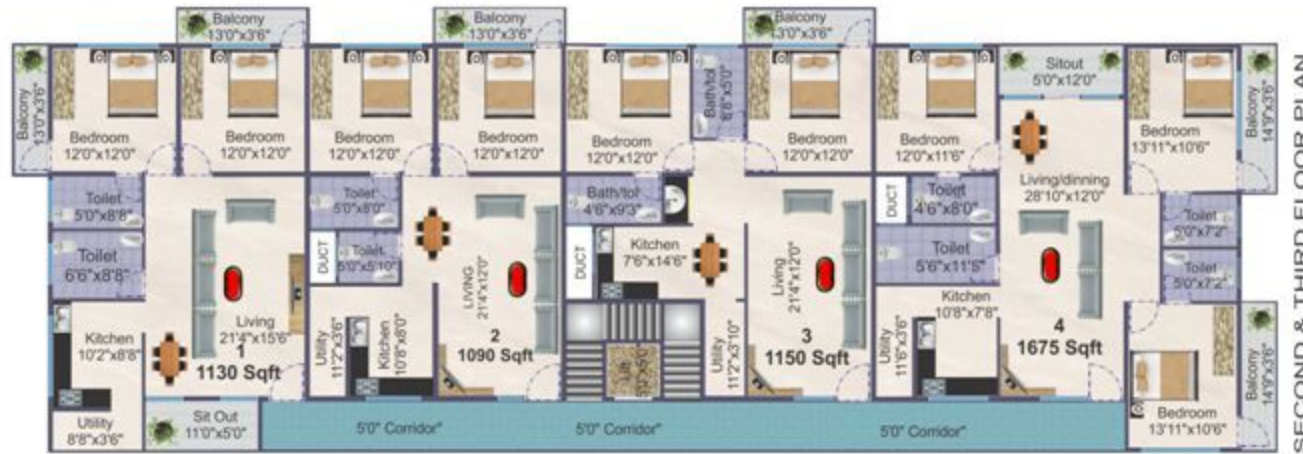

"The builder has the right information and looks at what is required for all"



Padma Priya
Seyon

Typical Floor Plan

Flat NO. 1 East facing
Ground, 1st, 2nd and 3rd Floor
1130 Sqft

Flat NO. 2 East facing
Ground, 1st, 2nd and 3rd Floor
1090 Sqft

Flat NO. 3. East facing
Ground, 1st, 2nd and 3rd Floor
1150 Sqft

Flat NO. 4 East facing
2nd and 3rd Floor
1675 Sqft



Padma Priya Seyon

About

We "Padma Priya Developers" believe in developing and constructing aesthetically designed, functionally efficient residential and commercial complexes of good quality, offering "more value for your money".

We believe that our buildings reflect engineering excellence with a view to provide complete customer satisfaction. It is our intention that the quality of our products and services should result in complete value for our clients.

Customer's Satisfaction

Padma Priya Seyon, located at JP Nagar 9th Phase, Gottigere Kembathalli Main Road, consisting of 2 & 3 BHK luxurious apartments are set to inspire all your senses. It is well connected to the Bannergatta Road, and NICE corridor Kanakapura Main Road. This artery offers easy accessibility to educational institutions, Hospitals, Shopping Centers, Restaurants. These apartments are especially designed on the principles of vastu and free flow of natural light and air.

Specifications



Structure

Rcc framed structure with solid cement block masonry paneled walls. External walls with 6" and internal walls with 4" solid concrete blocks.



Flooring

Vitrified tiles for flooring except toilet & utility. Good quality ceramic tiles for toilet & utility places



Doors & Windows

Teak Wood Vascal With Polishable Flush main door. For rooms salwood frame and flush shutters. powder coated aluminum windows with safety grills.



Kitchen

Black granite platform, with stainless steel sink. ceramic tile dadoing up to 2'0" above granite platform. Provision for cabinet. Good quality c.p. fitting & accessories etc.



Toilets

Toilets with anti-slippery flooring. ceramic/ glazed tiles dado upto 7'0" height. Good quality S.S (isi)/ c.p. fittings & accessories.



Lift

6 Passenger lift of standard make.



Wall finishing

Internal walls painted with tractor emulsion paint with pleasing Shades. External walls with weather coat/weather shield paint. enamel paint for grills & railings



Electrical

Concealed conduct with copper wiring using ISI brand materials with semi modular switches.



Amenity

Power Backup with generator, Car parking, Rain water Harvesting, 24/7 Security & Intercom Facility,





Flat NO. 1

**Ground, 1st, 2nd and 3rd Floor
1130 Sqft**



Flat NO. 2

**Ground, 1st, 2nd and 3rd Floor
1090 Sqft**





Flat NO. 3

Ground, 1st, 2nd and 3rd Floor
1150 Sqft



Flat NO. 4

Ground, 1st, 2nd and 3rd Floor
1675 Sqft



Padma Priya

Seyon

Location Advantages :

- ❖ 5 Minutes Drive From Meenakshi Mall
- ❖ 15 Minutes Drive From Jayanagar 9th Block
- ❖ 5 Minutes Drive From Kanakapura Main Road

Education Institites :

- ❖ Chitanya Techno School
- ❖ T John Engineering College
- ❖ Sherwood School
- ❖ Kumaran's School
- ❖ Capital School

Hospitals :

- ❖ Apollo Hospital
- ❖ Fortis Hospital
- ❖ Vijayashree Hospital

Super Markets :

- ❖ Royal Meenakshi Mall
- ❖ Food World
- ❖ METRO Cash & Carry
- ❖ Big Bazaar
- ❖ Capital School



**Loans arranged by
all leading Banks**



How To Reach



Note: The Company reserves the right to revise specifications without notice or obligation.
All photos & illustrations are representative & should be used as a guide only.